

1 2 3 4 5 6 7 8

REVISIONS		
ISS	ZONE	DESCRIPTION\PER REQUEST\DATE

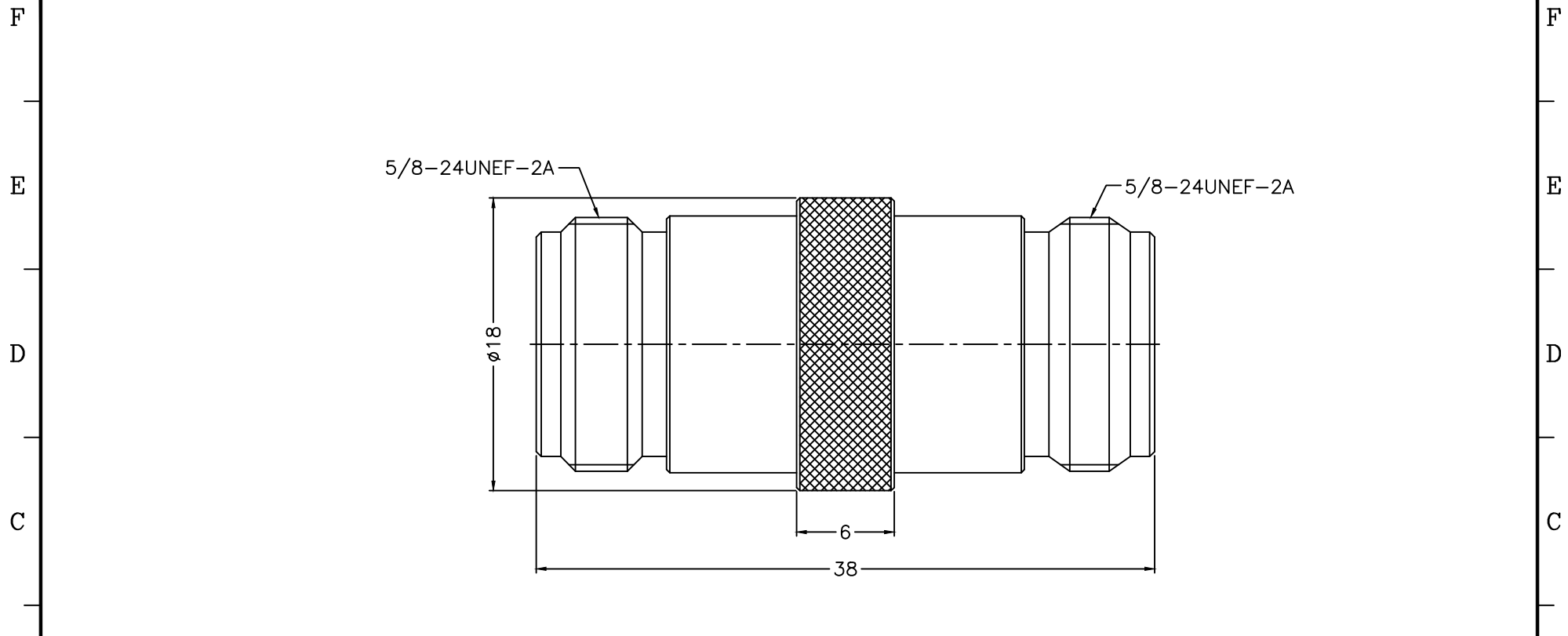

NOTES: FINISH (PLATING THICKNESS IN MICRO-INCHES)
 1. BRASS
 2. NICKEL PL. 100 MIN. THICK OVER COPPER PL. 50 MIN. THICK
 3. PHOSPHOR BRONZE
 4. GOLD PL. 3 MIN. THICK OVER NICKEL PL. 50 MIN. THICK OVER COPPER PL. 50 MIN. THICK
 5. TEFLON

					DIMENSIONS ARE IN MILLIMETERS				PART NO.		G.L.I.	
					UNLESS OTHERWISE SPECIFIED TOLERANCES				APPROVED	DATE		
					0.5-6 = ± 0.2					12-27-'12	N JACK TO JACK ADAPTOR	
					6-30 = ± 0.4				CHECKED	DATE	DRAWING NO.	
					30-120 = ± 0.6					12-27-'12	5824-7071A1-50	
					120-315 = ± 1				DRAWN	DATE	FILE NO.	
					315-1000 = ± 1.6					12-27-'12	R:\D\G\DWG\5824\7071A1\50	
					1000-2000 = ± 2.4				SCALE	3/1	ISSUE	A

4	BODY	NOTE 1	NOTE 2	1	5824-7071A1-4
3	CONTACT PIN	NOTE 3	NOTE 4	1	5824-7471A1-3
2	INSULATOR	NOTE 5	NATURAL	1	5824-7471A1-2
1	HOUSING	NOTE 1	NOTE 2	1	5824-7071A1-1
NO.	DESCRIPTION	MATERIAL	FINISH	Q'TY	DRAWING NO.

1 2 3 4 5 6 7 8