

1	2		3	4	5	6	7	8
REVISIONS								
ISS	ZONE	DESCRIPTION\PER REQUEST\DATE						

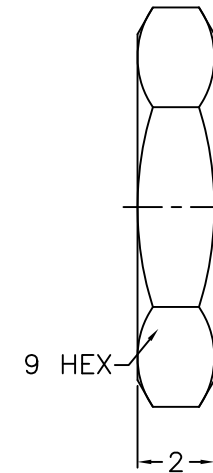
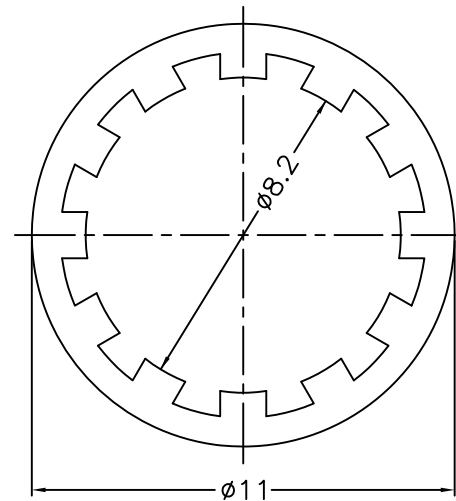
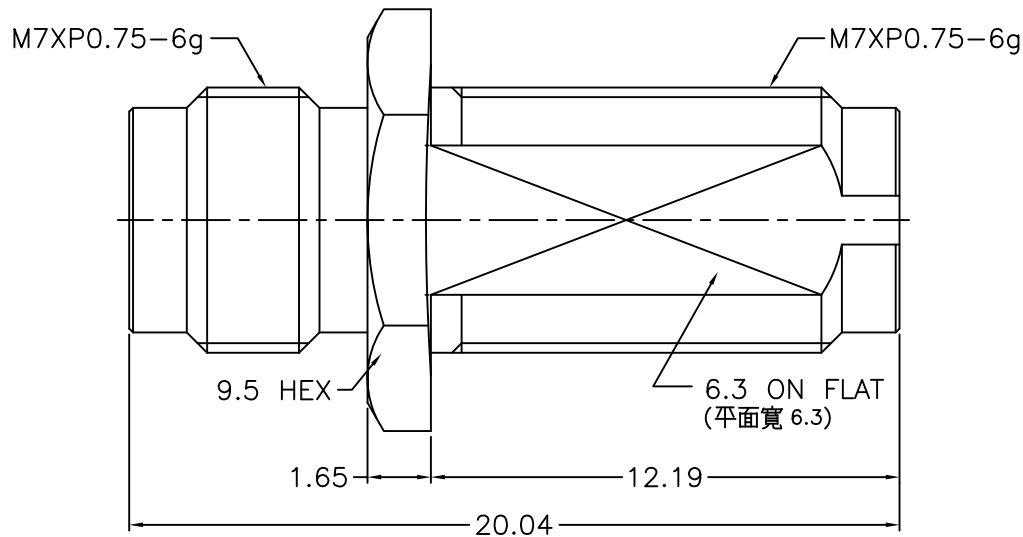

NOTES: FINISH (PLATING THICKNESS IN MICRO-INCHES)

1. STAINLESS STEEL
2. PASSIVATED
3. BERYLLIUM COPPER
4. GOLD PL. 10 MIN. THICK OVER NICKEL PL. 50 MIN. THICK OVER COPPER PL. 50 MIN. THICK
5. ULTEM 1000
6. BRASS
7. NICKEL PL. 100 MIN. THICK OVER COPPER PL. 50 MIN. THICK

RoHS COMPLIANT

					DIMENSIONS ARE IN MILLIMETERS				PART NO.		G.L.I.	
					UNLESS OTHERWISE SPECIFIED TOLERANCES				APPROVED			
					0.5-6 = ±0.2				DATE		2.4mm BULKHEAD JACK TO JACK ADAPTOR	
					6-30 = ±0.4				DATE		DRAWING NO.	
					30-120 = ±0.6				DATE		24-7471S1-50	
					120-315 = ±1				DATE		FILE NO.	
					315-1000 = ±1.6				DATE		R:\D\DWG\24\7471S1\50	
					1000-2000 = ±2.4				DATE			
					SCALE 5/1 ISSUE 1				DRAWN ALAN			
									DATE			
									12-23-'20			

6	HEX NUT	NOTE 1	NOTE 2		
5	LOCK WASHER	NOTE 1	NOTE 2		
4	RING	NOTE 6	NOTE 7		
3	CONTACT PIN	NOTE 3	NOTE 4		
2	INSULATOR	NOTE 5	NATURAL		
1	BODY	NOTE 1	NOTE 2		
NO.	DESCRIPTION	MATERIAL	FINISH	Q'TY	DRAWING NO.