

		1		2		3		4		5		6		7		8	
REVISIONS																	
ISS	ZONE	DESCRIPTION\PER REQUEST\DATE															

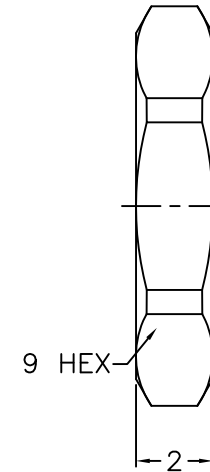
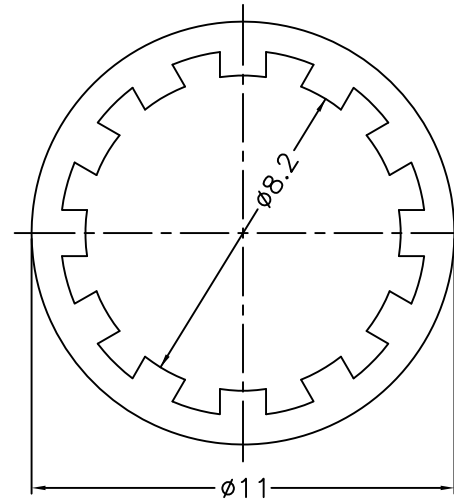
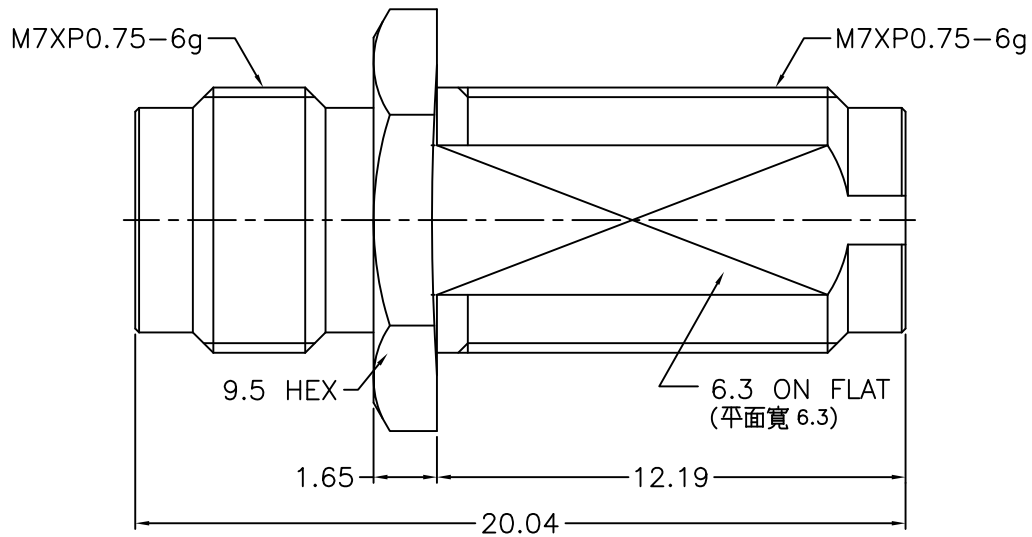

NOTES: FINISH (PLATING THICKNESS IN MICRO-INCHES)

1. STAINLESS STEEL
2. PASSIVATED
3. BERYLLIUM COPPER
4. GOLD PL. 10 MIN. THICK OVER ELECTROLESS NICKEL PL. 100 MIN. THICK
5. ULTEM 1000
6. BRASS
7. NICKEL PL. 100 MIN. THICK OVER COPPER PL. 50 MIN. THICK

RoHS COMPLIANT

DIMENSIONS ARE IN MILLIMETERS										PART NO.				<b>G.L.I.</b>			
UNLESS OTHERWISE SPECIFIED TOLERANCES										APPROVED		DATE					
0.5-6 = ±0.2												01-12-'21		1.85mm BULKHEAD JACK TO JACK ADAPTOR			
6-30 = ±0.4										CHECKED		DATE		DRAWING NO.			
30-120 = ±0.6												01-12-'21		185-7471S1-50			
120-315 = ±1										DRAWN		DATE		FILE NO.			
315-1000 = ±1.6										ALAN		01-12-'21		R:\D\DWG\185\7471S1\50			
1000-2000 = ±2.4																	
6	HEX NUT	NOTE 1	NOTE 2			SCALE	5/1	ISSUE	1								
5	LOCK WASHER	NOTE 1	NOTE 2														
4	RING	NOTE 6	NOTE 7														
3	CONTACT PIN	NOTE 3	NOTE 4														
2	INSULATOR	NOTE 5	NATURAL														
1	BODY	NOTE 1	NOTE 2														
NO.	DESCRIPTION	MATERIAL	FINISH	Q'TY	DRAWING NO.												

		1		2		3		4		5		6		7		8	
--	--	---	--	---	--	---	--	---	--	---	--	---	--	---	--	---	--